

# D SERIES 19" SWING FRAME WALL MOUNT CABINETS WITH REVERSIBLE BACKMOUNT

## DESCRIPTION

The DYNAMIX D series wall cabinets have a reversible left or right swinging backmount with large rear cable entry access. The cabinets are supplied standard with a range of accessories included such as 6 way PDU, fixed shelf and cage nuts depending on the model. They incorporate a unique drop in fan tray for ease of future servicing requirements and bonding earth wire for front door & backmount. Ease of access is provided by a reversible safety glass front door and removable side panels all lockable with a universal key.

## FEATURES

- Supplied complete, no assembly required
- Removable back mount supplied with left & right hinges
- 100mm back mount with cable entry rear, top & bottom
- 6 Way horizontal PDU included (12RU and above only)
- 1 fixed shelf (Excludes 4RU) & 10 cage nuts included
- Drop in dual fan kit (Excludes 450mm Deep Models)
- Removable lockable side panels
- Reversible lockable safety glass front door
- Bonding earth wire installed
- Gloss black colour, easy clean surface
- Max loading: 60kg
- Complies to IEC-60297, ANSI/EIA RS-310-D, IEC297-2, DIN41491; PART1, DIN41494; PART7, GB/T3047.2-92 standards.
- 2 Year warranty subject to use within the static loading specifications, operation within normal environmental conditions and adequate and appropriate mounting installation plus a 1 year Warranty on fans.



RSFDS12-600 Cabinet



RSFDS6-450 Cabinet





Side Access Panels

PRODUCT CODE	EXTERNAL DIMENSIONS W X D X H	HEIGHT	6 WAY PDU	BACKMOUNT HOLE SIZE	FIXED SHELVES	DEFAULT RAIL DEPTH	M <sup>3</sup>	KG
RSFDS4-450	600x450x281mm	4RU	0	320x200mm	0	238	0.15	20
RSFDS6-450	600x450x366.7mm	6RU	0	320x200mm	1	238	0.19	23
RSFDS6	600x550x366.7mm	6RU	0	320x200mm	1	288	0.16	23
RSFDS9	600x550x500mm	9RU	0	320x450mm	1	288	0.25	26
RSFDS12	600x550x650mm	12RU	1	320x450mm	1	288	0.31	31
RSFDS12-600	600x600x650mm	12RU	1	320x450mm	1	338	0.33	34
RSFDS18	600x550x908.3mm	18RU	1	320x450mm	1	288	0.42	34
RSFDS18-600	600x600x908.3mm	18RU	1	320x450mm	1	338	0.46	43
RSFDS24	600x550x1175mm	24RU	1	320x450mm	1	228	0.54	50
RSFDS24-600	600x600x1175mm	24RU	1	320x450mm	1	338	0.58	52
RSFDS27-600	600x600x1308.4mm	27RU	1	320x450mm	1	338	0.64	56

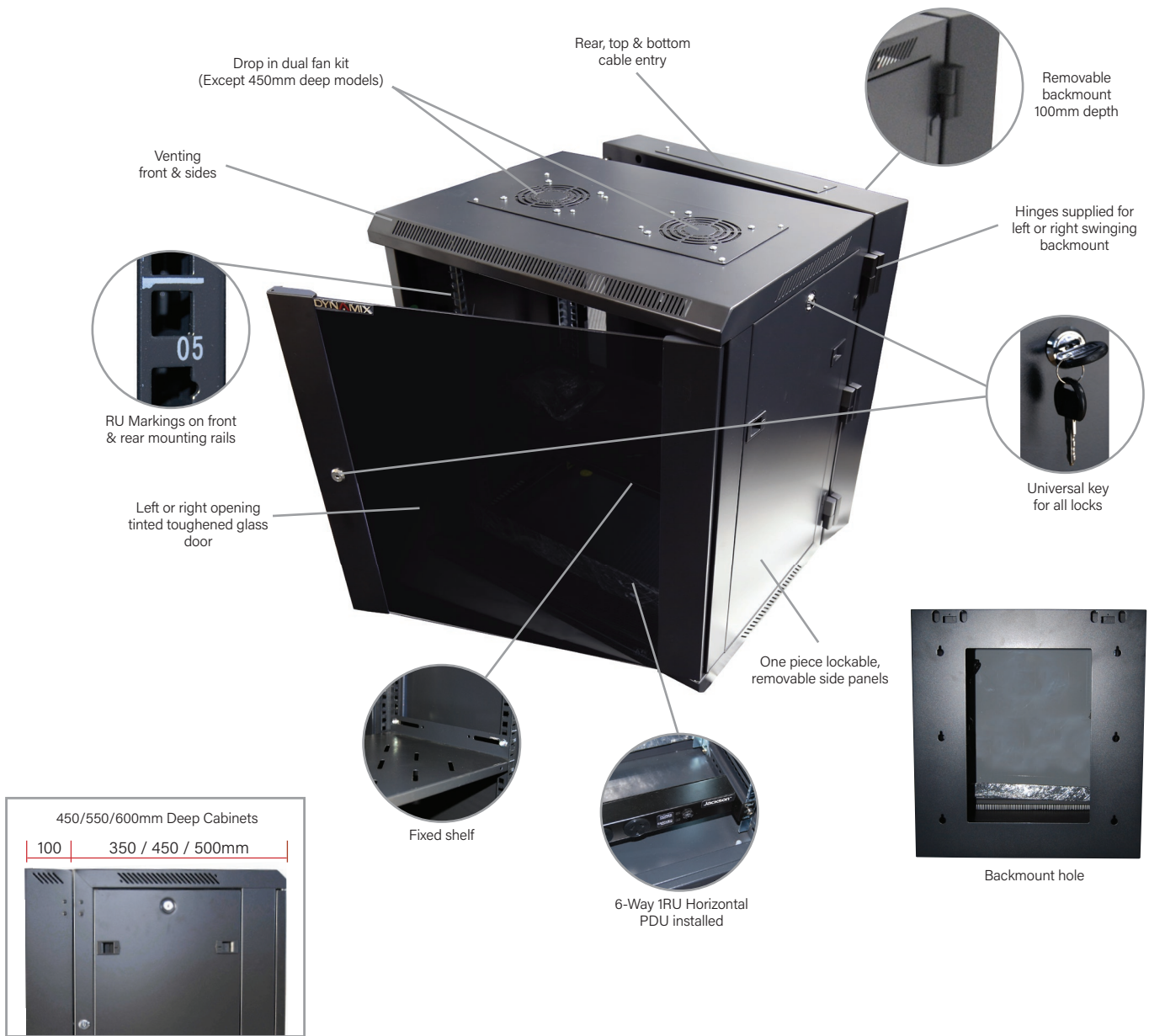
**SPECIFICATIONS**

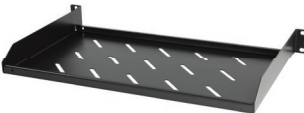

**ALSO AVAILABLE:**

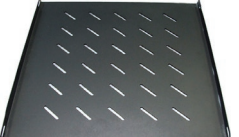
 <p><b>PP-CM001</b> 19" Cable Management Bar. Supplied with Cage Nuts. 70mm Deep.</p>	 <p><b>RACS-275</b> 1RU 19" Cantilever Shelf. Overall Depth: 275mm. Weight Rating: 15kg. Black Colour</p>	 <p><b>RAFS-290</b> Fixed Shelf for 550mm Wall Mount Cabinet, 275mm Depth.</p>	 <p><b>RAFS-340</b> Fixed Shelf for 600mm Deep Wall Mount Cabinet, 325mm Depth.</p>
--	--	--	--

Please note we took the up-most care to compile the information in this datasheet. To the best of our knowledge all info provided were correct at the time of creation. Should any specs change we try to update info accordingly. Information are subject to change without notice. In the case that you find any irregularity please inform our team at [contactus@dynamix.co.nz](mailto:contactus@dynamix.co.nz)  
Last updated: 28 July 2021